



BACnet Carbon Dioxide (CO₂) Detector/Transmitter

with Temperature and RH% Option

Model#: G01-CO2-N10C/30C

FEATURES

- BACnet communication
- CO₂ detection with 0~2000ppm range
- 0~5000ppm/0~50000ppm range selectable
- NDIR infrared CO₂ sensor with More than 10 years lifetime
- Patented self-calibration algorithm
- Optional temperature and humidity detection
- Provide up to 3xanalog linear outputs for measurements
- Optional LCD display of CO₂ and temperature and humidity
- 24VAC/VDC power supply
- EU standard and CE-approval

SPECIFICATIONS

CO ₂ Measurement		
Sensing element	Non-Dispersive Infrared Detector (NDIR)	
CO ₂ range	0~2000ppm 0~5,000ppm/0~50,000ppm optional	
CO ₂ Accuracy	±30ppm + 3% of reading @22°C (72°F)	
Temperature dependence	0.2% FS per °C	
Stability	<2% of FS over life of sensor (15 year typical)	
Pressure dependence	0.13% of reading per mm Hg	
Calibration	ABC Logic Self Calibration Algorithm	
Response time	<2 minutes for 90% step change typical	
Signal update	Every 2 seconds	
Warm-up time	2 hours (first time) / 2 minutes (operation)	
	Temperature	Humidity
Measuring range	0°C~50°C (32°F~122°F) (default)	0 -100%RH
Accuracy	±0.4°C (20°C~40°C)	±3%RH (20%-80%RH)

Display resolution	0.1°C	0.1%RH
Stability	<0.04°C/year	<0.5%RH/year
General Data		
Power supply	24VAC/VDC±10%	
Consumption	2.2 W max. ; 1.6 W avg.	
Analog outputs	1~3 X analog outputs 0~10VDC(default) or 4~20mA (selectable by jumpers) 0~5VDC (selected at placing the order)	
Operation conditions	0~50°C (32~122°F); 0~95%RH, non condensing	
Storage conditions	10~50°C (50~122°F) 20~60%RH	
Net Weight	250g	
Dimensions	130mm(H)×85mm(W)×36.5mm(D)	
Installation	wall mounting with 65mm×65mm or 2"×4" wire box	
Housing and IP class	PC/ABS fireproof plastic material, protection class: IP30	
Standard	CE-Approval	

MODEL GUIDE

G01-CO2-N X 0 C -Y 0 1 -U 02/05/50 -T/TH -Txx

X: LCD or no LCD

- 1-** Without LCD, 24VAC/VDC power supply
- 3-** LCD display, 24VAC/VDC power supply

C: 24VAC/VDC power supply

Y: analog output quantity

- 3-** 3Xanalog outputs (for CO2, temperature, humidity)
- 2-** 2Xanalog outputs (for CO2, temperature)
- 1-** 1xanalog output (for CO2)
- 0-** no analog output

U: type of analog output

- V-** 0~10VDC (default)
- A-** 4~20mA
- V5-** 0~5VDC (not be changed)

02/05/50: CO2 range

- 02-** 0~2,000ppm
- 05-** 0~5,000ppm
- 50-** 0~50,000ppm

T/TH: temperature option/ temperature and humidity option

Txx: temperature scaling

T05: 0°C~50°C (32°F~122°F) default (without the postfix indicates the default)

T06: 0°C~60°C (32°F~140°F)

T26: -20°C~60°C (-4°F~140°F)

Accessory (selectable in the order)

921: wall mounting plate

■ Mounting and Dimensions

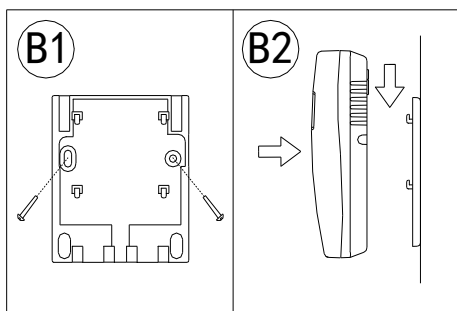
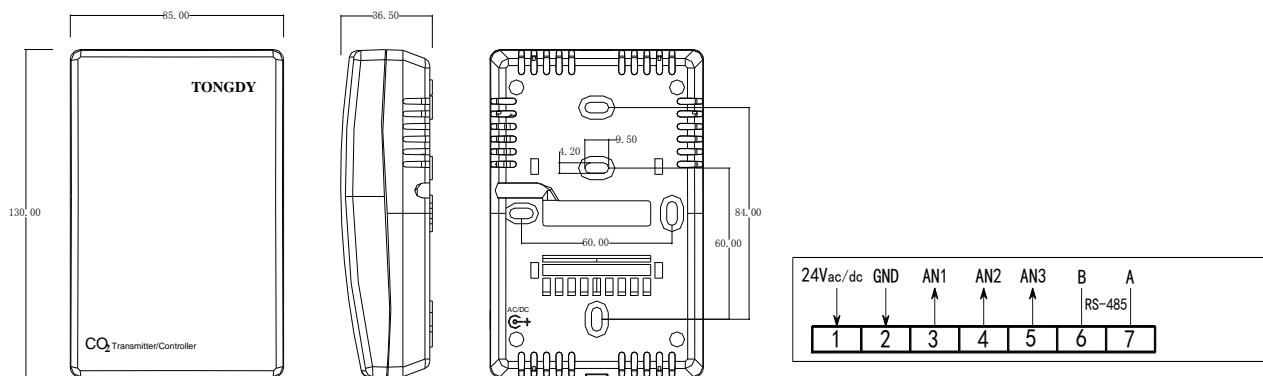

921-Wall mounting plate